

Location of Controls (Top)

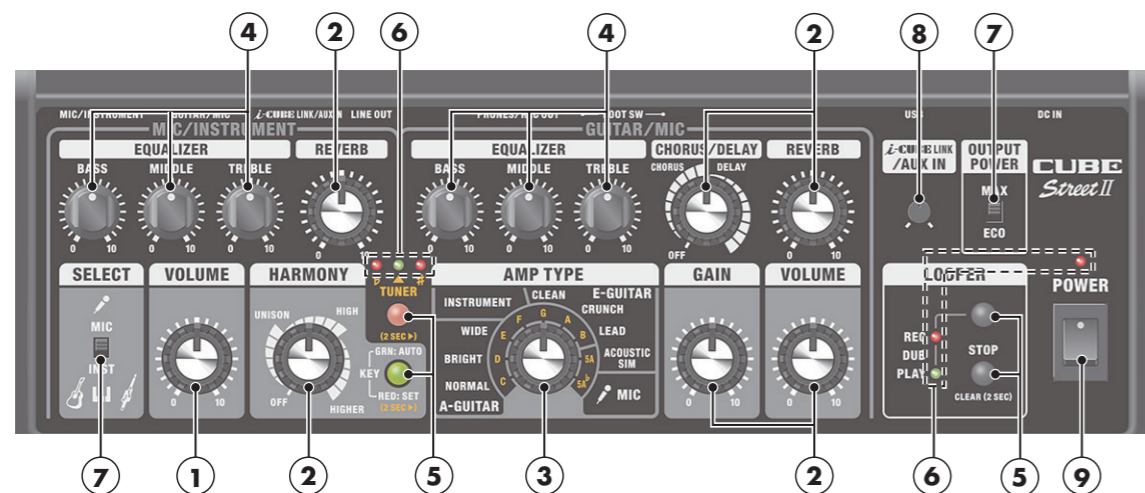

Location of Controls (Top) Parts List

No.	Part Code	Part Name	Description	Q'ty
1	5100038983	R-KNOB	SF BLK/SLV	1
	510005633	ROTARY POTENTIOMETER	RD901F-40E1-15F-1B100K-00DN6	1
2	5100038983	R-KNOB	SF BLK/SLV	6
	5100067364	ROTARY POTENTIOMETER	RV09BDF-40E1-15F-0B10K-003	6
3	5100038983	R-KNOB	SF BLK/SLV	1
	5100074023	ROTARY POTENTIOMETER	RD901F-40-15F-B10K-09D90B SCF	1
4	5100023950	R-KNOB		6
	5100067364	ROTARY POTENTIOMETER	RV09BDF-40E1-15F-0B10K-003	6
5	5100075368	CUSHION	KEYTOP	4
	5100074399	KEYTOP		4
6	5100074400	LED LENS		2
7	5100007726	SWITCH	SS71010F-0102-6T-015-NP	2
8	03231723	9M/M ROTARY POTENTIOMETER	RK09K1130A5R	1
9	02897801	SEESAW SWITCH	SDDJE13200 94V-0	1

Location of Controls (Rear)

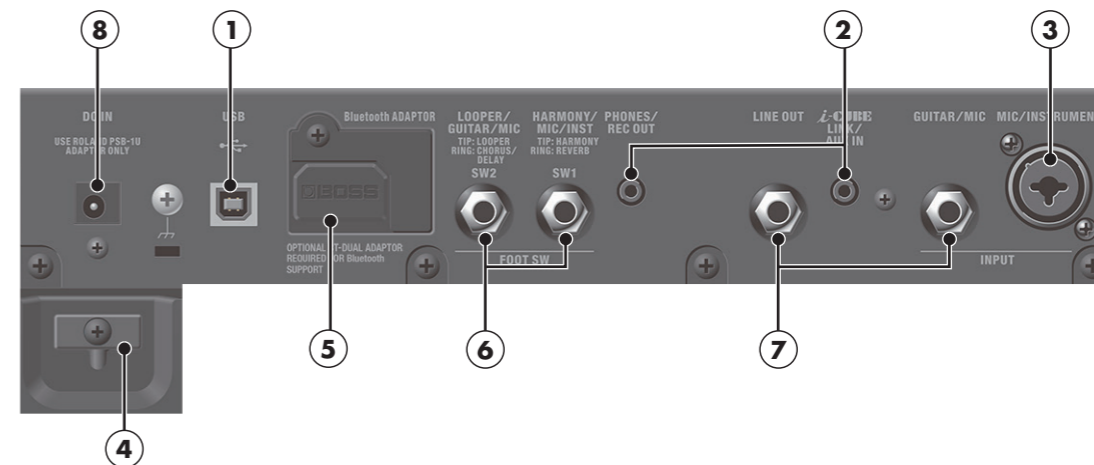

Location of Controls (Rear) Parts List

No.	Part Code	Part Name	Description	Q'ty
1	5100009531	USB CONNECTOR B TYPE FEMALE	YKF45-0044N	1
2	5100037105	3.5MM JACK	LJE0393-7	2
3	5100013062	CANNON CONNECTOR	CT/PJ-02-07EP	1
4	5100060615	CORD HOOK		1
5	5100074427	BT DUAL COVER		1
6	5100031944	6.5MM JACK	PJ-644C-EP	2
7	5100024419	6.5MM JACK	PJ-644C-04-EP(610-11020-01-00)	2
8	5100053031	DC JACK	KM02018ASBM1P	1

Exploded View

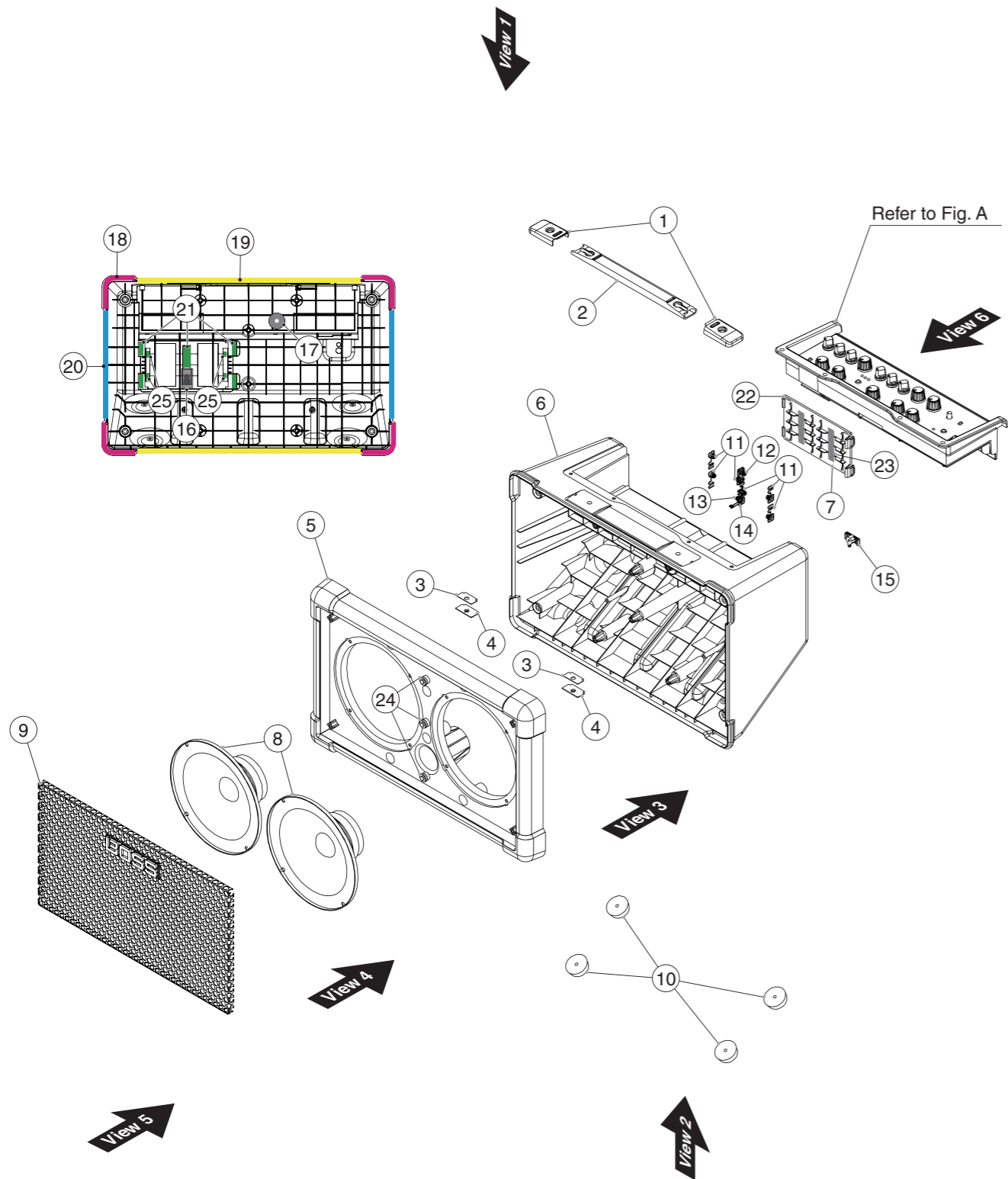

Exploded View Parts List

No.	Part Code	Part Name	Description	Q'ty
1	5100011383	HANDLE HOLDER		2
2	5100011381	HANDLE	716-11038-01-00	1
	5100011382	HANDLE PLATE	750-11038-03-00	1
3	5100074402	HIMELON	HANDLE	2
4	5100074401	HANDLE HOLDER PLATE		2
5	5100074391	FRONT CASE	BLACK for CUBE-ST2	1
	5100074380	FRONT CASE	RED for CUBE-ST2-R	1
6	5100074376	REAR CASE	BLACK for CUBE-ST2	1
	5100074350	REAR CASE	RED for CUBE-ST2-R	1
7	5100074432	BATTERY COVER		1
8	5100073862	SPEAKER	W6504-128A	2
9	5100073973	GRILLE ASSY	BLACK for CUBE-ST2	1
	5100073976	GRILLE ASSY	RED for CUBE-ST2-R	1
10	5100027159	RUBBER FOOT	D30.5XT9.5	4
11	5100036172	BATTERY TERMINAL		6
12	5100032971	BATTERY TERMINAL PM		1
13	5100060634	BATTERY TERMINAL	PLUS	1
14	5100060635	BATTERY TERMINAL	MINUS	1
15	5100060615	CORD HOOK		1
	5100073514	PANEL SHEET ASSY		1
* This unit includes the following parts.				
16	*****	TERMINAL BOARD		
	*****	PANEL BOARD		
	*****	INPUT BOARD		
17	5100017151	RUBBER SPONGE BUSHING		1
18	5100074404	HIMELON S		4
19	5100074405	HIMELON L		2
20	5100074403	HIMELON M		2
21	5100040917	CUSHION	GRILLE SIDE	5
22	5100056242	CUSHION BATTERY COVER	10X3X0.5	4
23	5100060980	CUSHION 53X16X2T		4
24	5100039421	CUSHION	GRILLE	3
25	5100078586	CUSHION	BATTERY CASE	4

Plain View

View 1

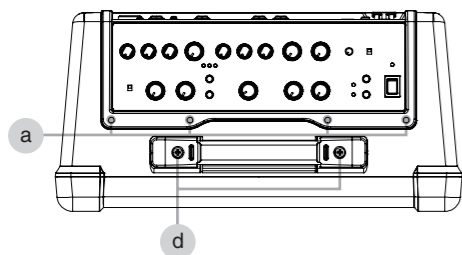

View 2

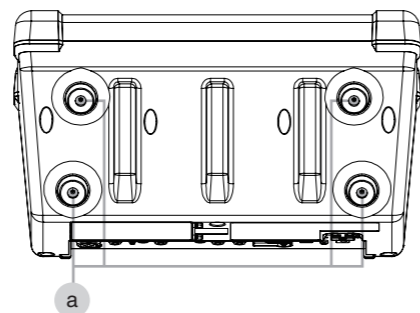

View 3

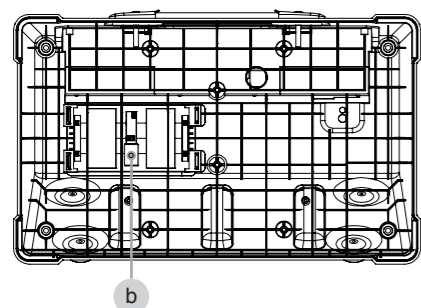

View 4

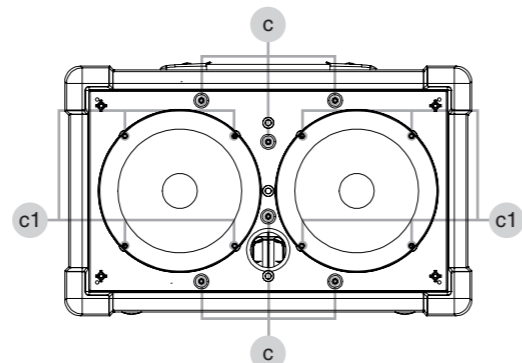

View 5

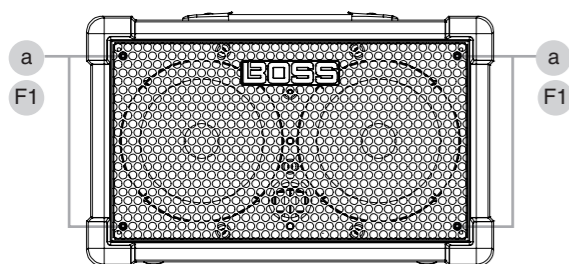

View 6

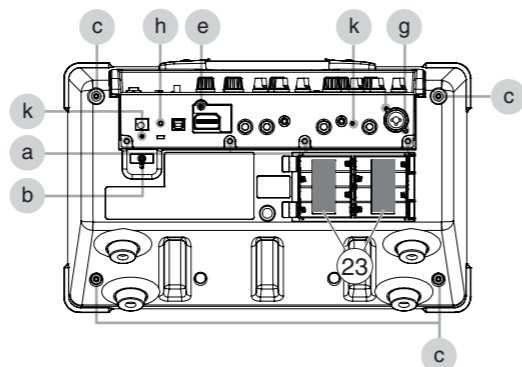

Plain View Parts List

View 1, 2

No.	Part Code	Part Name	Description	Q'ty
a	5100013786	SCREW 4X12(JC7000193R0)	TRUSS TAPTITE P BZC	8
d	40010478	SCREW M5X25	OVAL MACHINE FE BZC FOR HANDLE	2

View 3

No.	Part Code	Part Name	Description	Q'ty
b	40011267	SCREW 3X6	BINDING TAPTITE P FE ZC	1

View 4

No.	Part Code	Part Name	Description	Q'ty
c, c1	5100020467	SCREW 4X15(501-11044-06-00)	BINDING TAPTITE P BZC	14

View 5

No.	Part Code	Part Name	Description	Q'ty
a	5100013786	SCREW 4X12(JC7000193R0)	TRUSS TAPTITE P BZC	4
F1	5100005101	WASHER	RESIN 4.1X11X1 BLACK	4

View 6

No.	Part Code	Part Name	Description	Q'ty
23	5100060980	CUSHION 53X16X2T		2
a	5100013786	SCREW 4X12(JC7000193R0)	TRUSS TAPTITE P BZC	4
b	40011267	SCREW 3X6	BINDING TAPTITE P FE ZC	1
c	5100020467	SCREW 4X15(501-11044-06-00)	BINDING TAPTITE P BZC	4
e	5100075389	SCREW M3X13	BINDING MACHINE BZC	1
g	5100061604	SCREW 2.8X9	BINDING TAPTITE P BZC	2
k	40237101	SCREW M3X8	PAN MACHINE W/SW+SMALL PW BZC	2
h	40454856	SCREW M4X10	BINDING MACHINE NI	1

Exploded View (Fig. A)

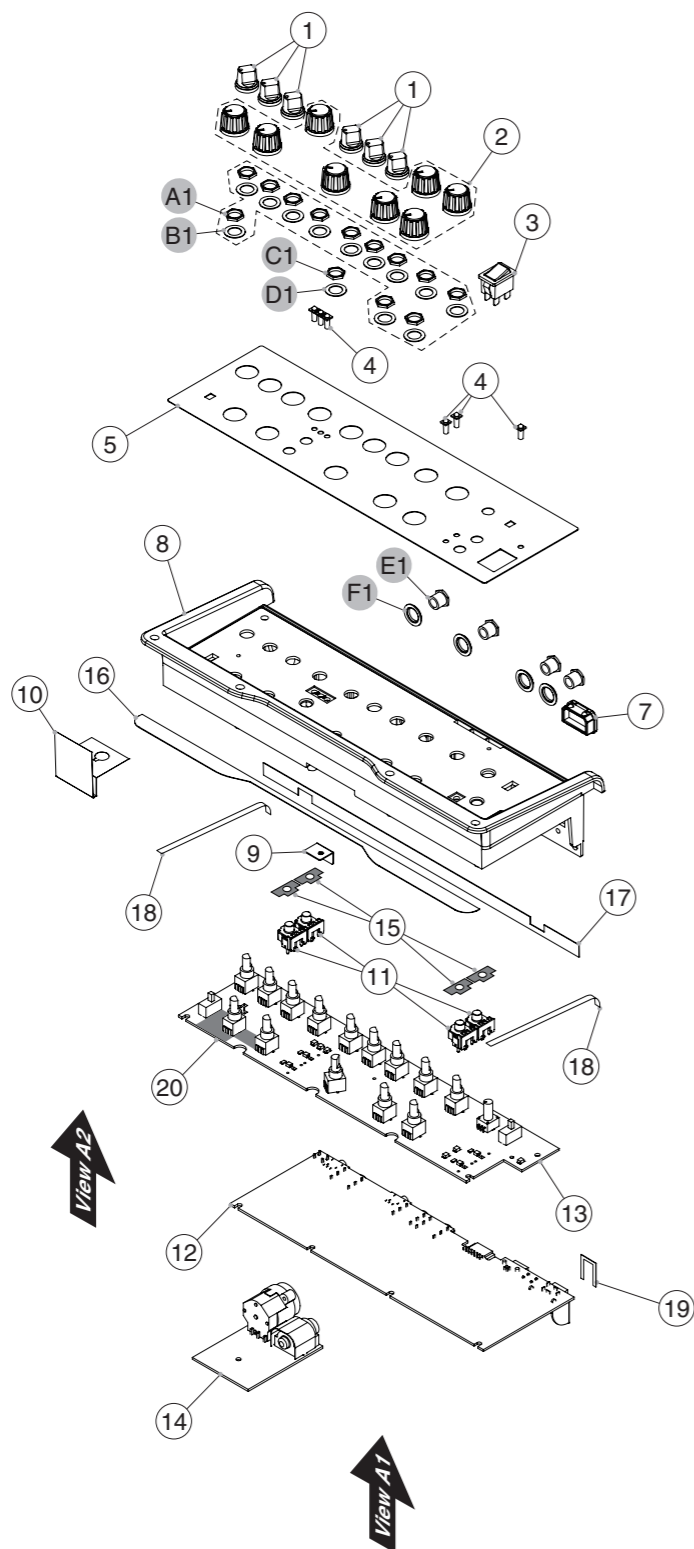

Exploded View (Fig. A) Parts List

No.	Part Code	Part Name	Description	Q'ty
1	5100023950	R-KNOB		6
2	5100038983	R-KNOB	SF BLK/SLV	8
3	02897801	SEESAW SWITCH	SDDJE13200 94V-0	1
4	5100074400	LED LENS		2
5	5100074392	PANEL SHEET		1
7	5100074427	BT DUAL COVER		1
8	5100074430	CHASSIS		1
9	5100074444	HOLDER		1
10	5100075390	SHIELD SHEET		1
11	5100074399	KEYTOP		4
12	5100076085	MAIN SHEET ASSY		1
	5100073514	PANEL SHEET ASSY		1
	* This unit includes the following parts.			
13	*****	PANEL BOARD		1
14	*****	INPUT BOARD		1
	*****	TERMINAL BOARD		1
15	5100075368	CUSHION	KEYTOP	4
16	5100039400	CUSHION B		2
17	5100074422	CUSHION C		1
18	5100074426	CUSHION A		1
19	5100026617	EVA PACKING(762-11034-01-00)	08489-543 (SD000445)	1
20	40122645	NITTO FILAMENT TAPE	#3883 W19MM 50M 60P (CM)	-
A1	*****	NUT	M9 attached to VR	13
B1	*****	WASHER	M9 attached to VR	13
C1	*****	NUT	M7 attached to VR	1
D1	*****	WASHER	M7 attached to VR	1
E1	*****	NUT	attached to JACK	4
F1	5100005101	WASHER	RESIN 4.1X11X1 BLACK	4

Plain View (Fig. A)

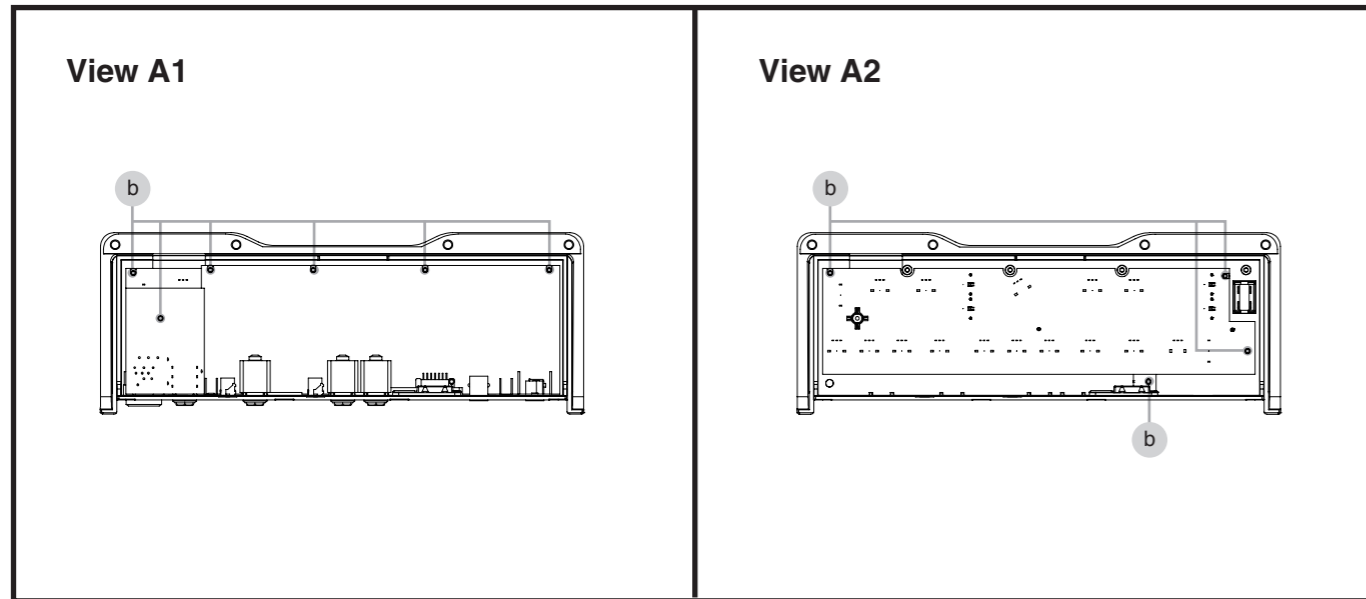

Plain View (Fig. A) Parts List

View A1, A2

No.	Part Code	Part Name	Description	Q'ty
b	40011267	SCREW 3X6	BINDING TAPTITE P FE ZC	10

Parts List

Due to one or more of the following reasons, parts with parts code ***** cannot be supplied as service parts.

- Supply is prohibited due to copyright restrictions.
- It is carried in electronic data on the Roland web site.
- The part is made to order (at current market price).
- It is a package or an accessory irrelevant to the function maintenance of the main body.
- Because it is sold as a product.
- Reissuance is restricted.
- It is supplied as an assembled part (under a different part code).
- It can be replaced with an article on the market. (battery or etc.)
- A number of circuit boards are grouped together and supplied as a single circuit board (under a different part code).

Note: The parts marked # are new. (initial parts) The description "Q'ty" means a necessary number of the parts per one product.

CASING

#	5100074391	FRONT CASE	BLACK	for CUBE-ST2	1
#	5100073973	GRILLE ASSY	BLACK	for CUBE-ST2	1
#	5100074376	REAR CASE	BLACK	for CUBE-ST2	1
#	5100074380	FRONT CASE	RED	for CUBE-ST2-R	1
#	5100073976	GRILLE ASSY	RED	for CUBE-ST2-R	1
#	5100074350	REAR CASE	RED	for CUBE-ST2-R	1
#	5100074432	BATTERY COVER			1
#	5100074427	BT DUAL COVER			1

CHASSIS

#	5100074430	CHASSIS			1
	5100011381	HANDLE	716-11038-01-00		1
	5100011382	HANDLE PLATE	750-11038-03-00		1
	5100011383	HANDLE HOLDER			2
#	5100074401	HANDLE HOLDER PLATE			2
#	5100074444	HOLDER			1

KNOB, BUTTON

	5100023950	R-KNOB			6
	5100038983	R-KNOB	SF BLK/SLV		8
#	5100074399	KEYTOP			4

SWITCH

	02897801	SEESAW SWITCH	SDDJE13200 94V-0		1
	5100007726	SWITCH	SS71010F-0102-6T-015-NP		2

JACK, EXT TERMINAL

	5100037105	3.5MM JACK	LJE0393-7		2
	5100024419	6.5MM JACK	PJ-644C-04-EP(610-11020-01-00)		2
	5100031944	6.5MM JACK	PJ-644C-EP		2
	5100013062	CANNON CONNECTOR	CT/PJ-02-07EP		1
	5100053031	DC JACK	KM02018ASBM1P		1
	5100009531	USB CONNECTOR B TYPE FEMALE	YKF45-0044N		1

SPEAKER, BUZZER

#	5100073862	SPEAKER	W6504-128A		2
---	------------	---------	------------	--	---

PWB ASSY

#	5100076085	MAIN SHEET ASSY			1
#	5100073514	PANEL SHEET ASSY			1
	* This unit includes the following parts.				
	*****	PANEL BOARD			1
	*****	INPUT BOARD			1
	*****	TERMINAL BOARD			1

POTENTIOMETER

	03231723	9M/M ROTARY POTENTIOMETER	RK09K1130A5R		1
	5100005633	ROTARY POTENTIOMETER	RD901F-40E1-15F-1B100K-00DN6		1
	5100067364	ROTARY POTENTIOMETER	RV09BDF-40E1-15F-0B10K-003		12
#	5100074023	ROTARY POTENTIOMETER	RD901F-40-15F-B10K-09D90B SCF		1

WIRING, CABLE

#	5100073756	WIRING	W1 (MAIN TO INPUT)	1
#	5100073757	WIRING	W2 (MAIN TO PANEL)	1
#	5100073759	WIRING	W3 (PANEL TO INPUT)	1
#	5100073787	WIRING	W4 (MAIN TO BATTERY BOX)	1
#	5100073788	WIRING	W5 (MAIN TO POWER SW)	1
#	5100073789	WIRING	W6 (MAIN TO SPEAKER)	1

SCREWS

	5100061604	SCREW 2.8X9	BINDING TAPTITE P BZC	2
	40011267	SCREW 3X6	BINDING TAPTITE P FE ZC	10
	40011323	SCREW 3X10	BINDING TAPTITE P BZC	1
	5100013786	SCREW 4X12(JC7000193R0)	TRUSS TAPTITE P BZC	16
	5100020467	SCREW 4X15(501-11044-06-00)	BINDING TAPTITE P BZC	18
#	5100075389	SCREW M3X13	BINDING MACHINE BZC	1
	40237101	SCREW M3X8	PAN MACHINE W /SW+SMALL PW BZC	2
	40454856	SCREW M4X10	BINDING MACHINE NI	1
	40010478	SCREW M5X25	OVAL MACHINE FE BZC FOR HANDLE	2
	5100005101	WASHER	RESIN 4.1X11X1 BLACK	8

MISCELLANEOUS

	5100026097	DC JACK HOLDER	(SD001047)	1
	5100060634	BATTERY TERMINAL	PLUS	1
	5100060635	BATTERY TERMINAL	MINUS	1
	5100036172	BATTERY TERMINAL		6
	5100032971	BATTERY TERMINAL PM		1
#	5100074392	PANEL SHEET		1
#	5100075390	SHIELD SHEET		1
	5100060615	CORD HOOK		1
#	5100074426	CUSHION A		1
	5100039400	CUSHION B		2
#	5100074422	CUSHION C		1
	5100039421	CUSHION	GRILLE	3
#	5100040917	CUSHION	GRILLE SIDE	5
#	5100078586	CUSHION	BATTERY CASE	4
#	5100075368	CUSHION	KEYTOP	4
	5100060980	CUSHION 53X16X2T		4
	5100056242	CUSHION BATTERY COVER	10X3X0.5	4
#	5100074405	HIMELON L		2
#	5100074403	HIMELON M		2
#	5100074404	HIMELON S		4
#	5100074402	HIMELON	HANDLE	2
#	5100074400	LED LENS		2
#	5100074406	ABSORPTIVE FOAM		1
	5100026617	EVA PACKING(762-11034-01-00)	08489-543 (SD000445)	1
	5100027159	RUBBER FOOT	D30.5XT9.5	4
	5100017151	RUBBER SPONGE BUSHING		1
	5100027814	LOCKING CABLE	TIE CV-100V0K	2
	40122645	NITTO FILAMENT TAPE	#3883 W19MM 50M 60P (CM)	-

ACCESSORIES (Standard)

	5100031008	4POLES MINI CABLE	452-12020-01-00	1
	5100047495	AC ADAPTOR WITHOUT AC CORD	PSB-1U(S)_2 (FOR EXEPT JAPAN)	1
	5100048283	AC CORD SET	100V EYEGLOSS ARK-VFF 1.0M	(19) for 100V 1
	5100003142	AC CORD	115VTW 1.0M FOR PSB	(25) for 115VTW 1
	5100000692	AC CORD SET	117V U 1.0M	(22, 28) for 117VU, 117VU/CS 1
	5100012293	AC CORD SET	117VBL 1.0M FOR PSB	(26) for 117VBL 1
	05017301	AC CORD SET	230V 1.0M FOR EU	(32) for 230VEU 1
	5100018086	AC CORD SET	230VE 1.0M FOR EPS	(49) for 230VE 1
	5100029122	AC CORD SET	240V 1.0M FOR PSB	(59) for 240VA 1
	5100000564	CORD SET (220V CN)	CN005	(65) for 220VCN 1
	5100039367	AC CORD	SF021A+IS037 220VK 2.5M 2P	(66) for 220VK 1
#	5100074448	OWNER'S MANUAL	CHINESE	1
#	5100074447	OWNER'S MANUAL	MULTILANGUAGE	1

Block & Wiring Diagram

No.	Part Code	Part Name	Description	Q'ty
W1	5100073756	WIRING	W1 (MAIN TO INPUT)	1
W2	5100073757	WIRING	W2 (MAIN TO PANEL)	1
W3	5100073759	WIRING	W3 (PANEL TO INPUT)	1
W4	5100073787	WIRING	W4 (MAIN TO BATTERY BOX)	1
W5	5100073788	WIRING	W5 (MAIN TO POWER SW)	1
W6	5100073789	WIRING	W6 (MAIN TO SPEAKER)	1

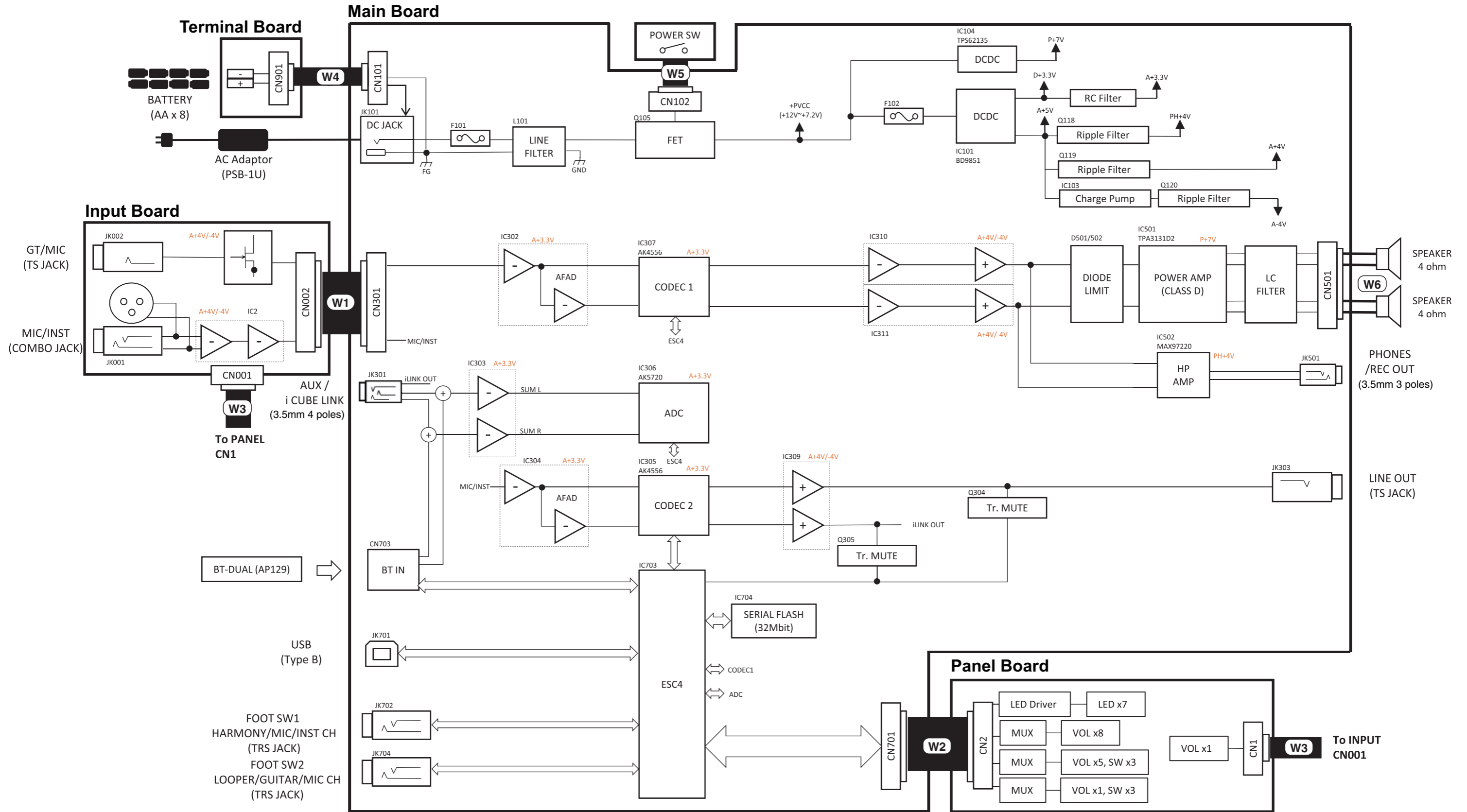

Circuit Diagram (Main Board: 1/4)

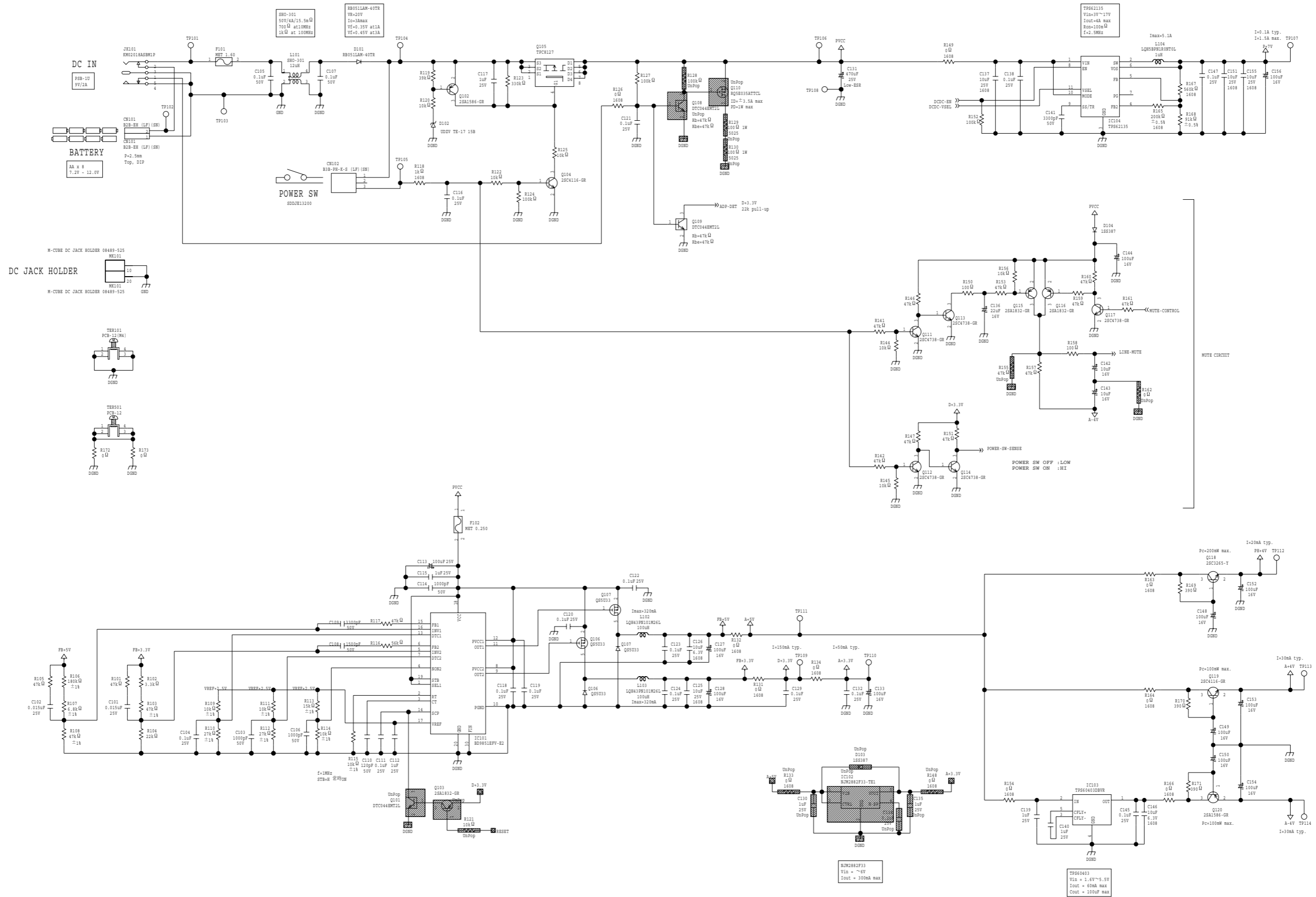

Circuit Diagram (Main Board: 3/4)

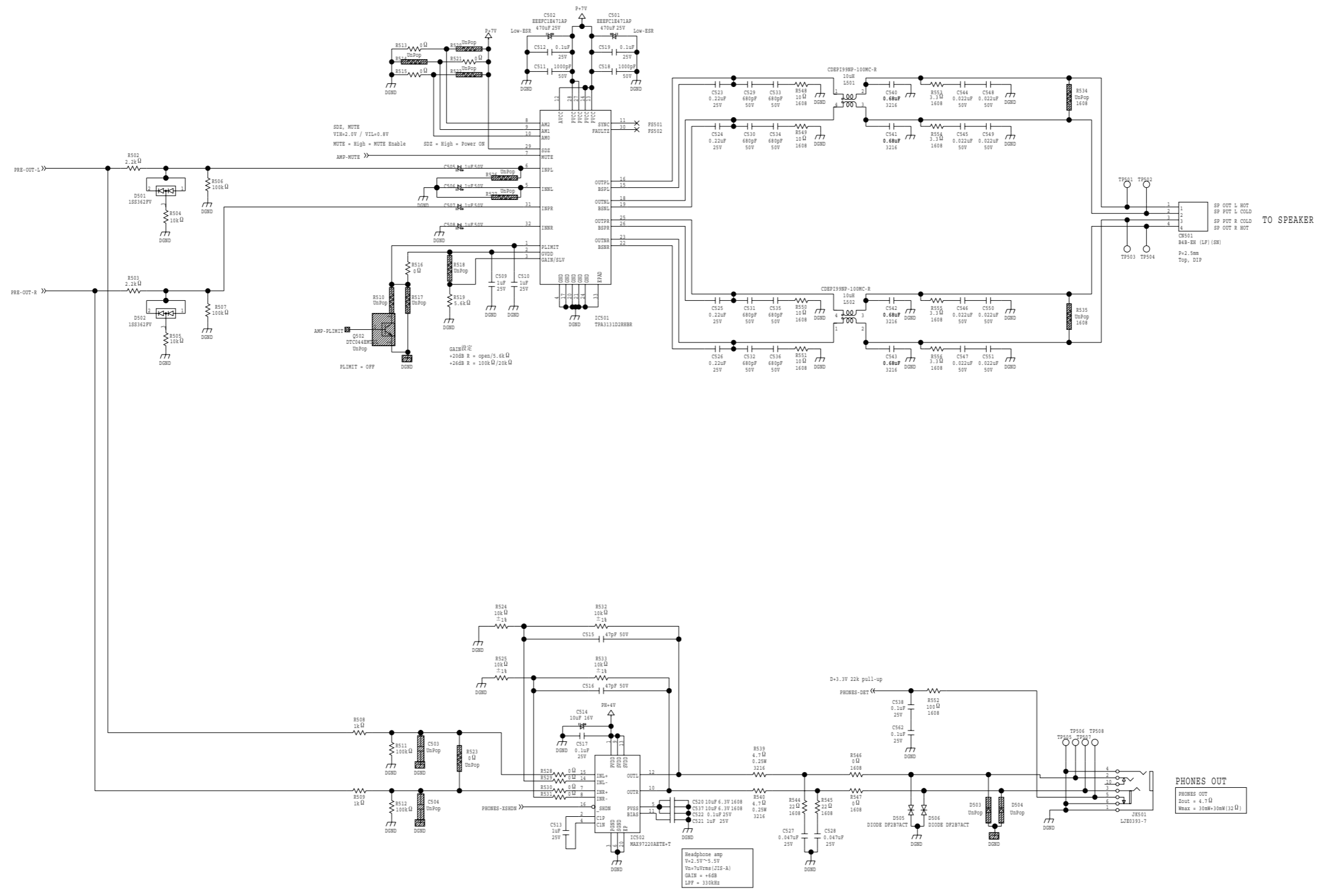

Circuit Board (Terminal, Panel, Input Board)

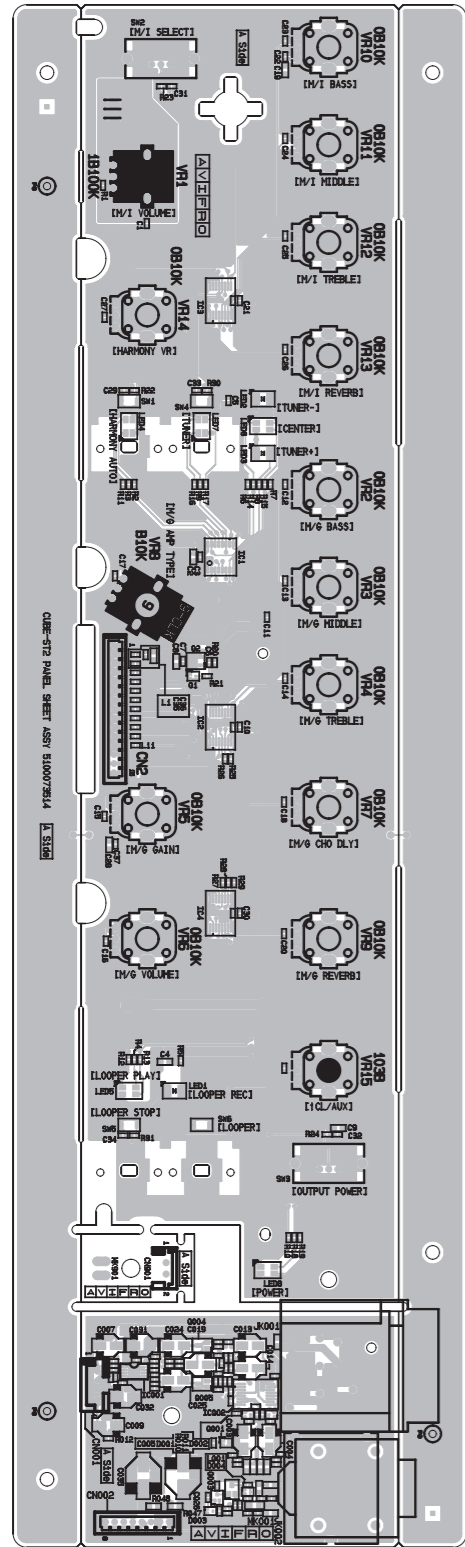

Circuit Diagram (Terminal Board)

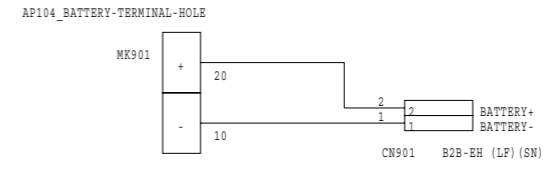
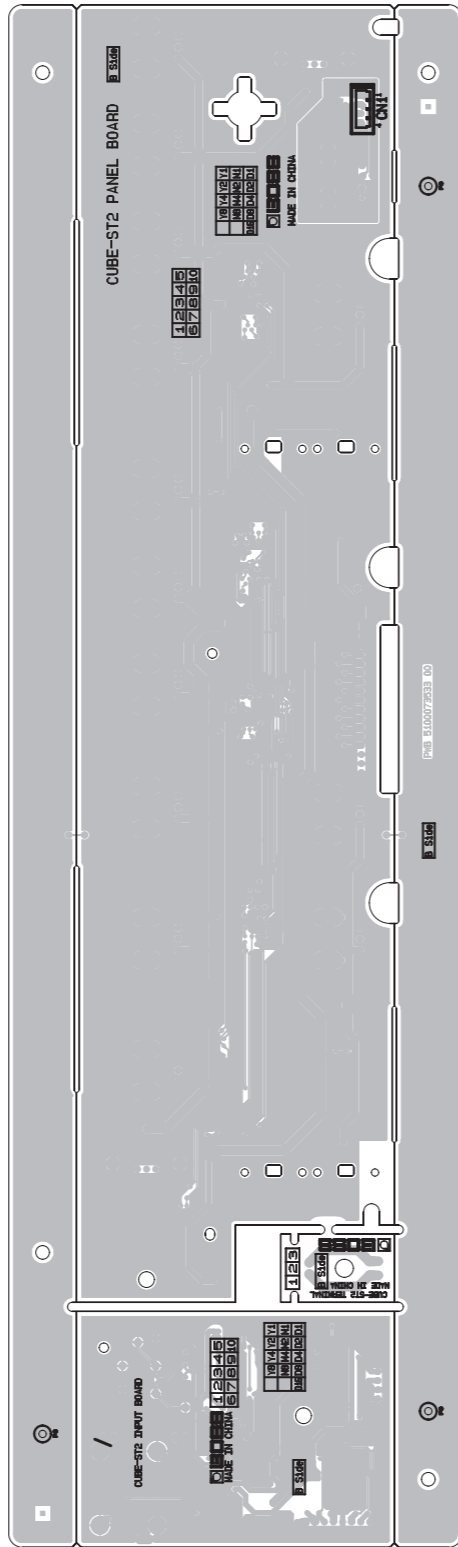

Circuit Diagram (Panel Board)

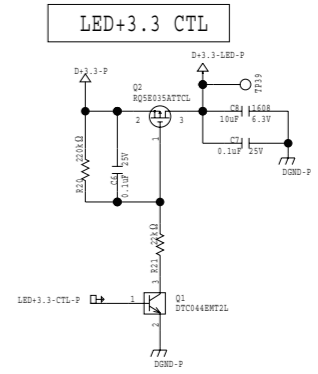
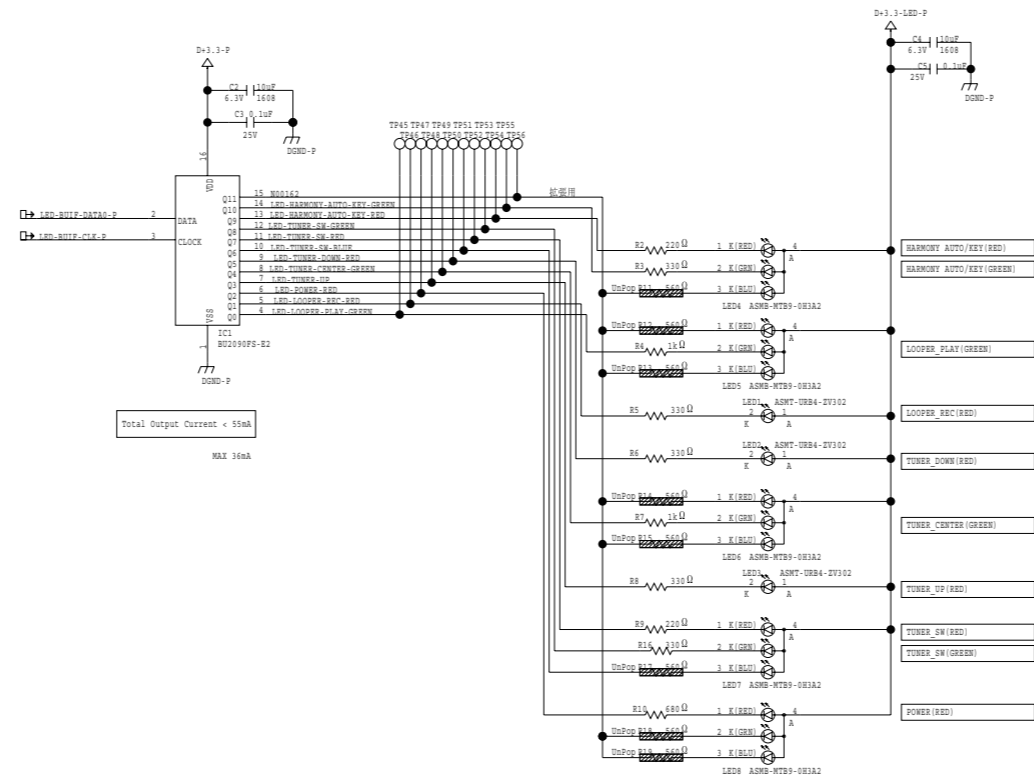
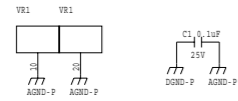
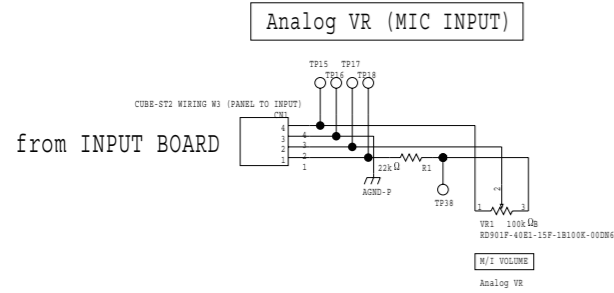

No.	NAME	TYPE
7	M/G BASS	VR
6	M/G MID	VR
5	M/G AMP TYPE	VRclick
4	M/G TREBLE	VR
3	M/G GAIN	VR
2	N/A	OMD
1	N/A	OMD
0	M/G CHO/DLY	VR

No.	NAME	TYPE
7	TUNER	SW
6	HARMONY VR	VR
5	HARMONY SW	SW
4	M/I SELECT	SW
3	M/I REVERSE	VR
2	M/I TREBLE	VR
1	M/I MIDDLE	VR
0	M/I BASS	VR

No.	NAME	TYPE
7	N/A	OMD
6	N/A	OMD
5	M/G VOLUME	VR
4	N/A	OMD
3	LOOPER	SW
2	M/G REV	VR
1	ICL/AUX	VR
0	OUTPUT POWER	SW

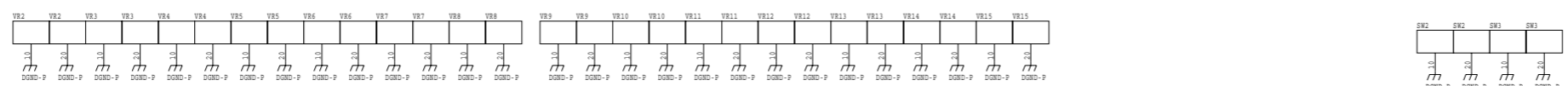
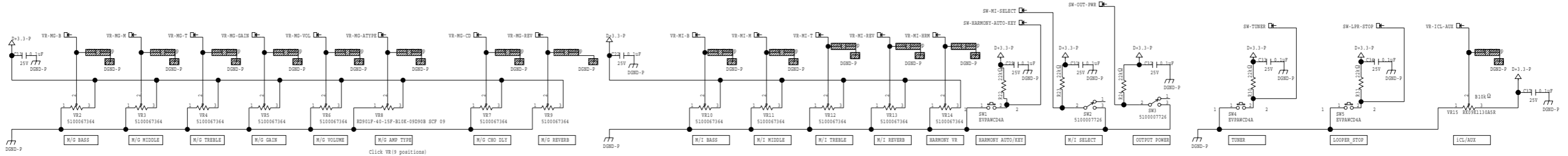
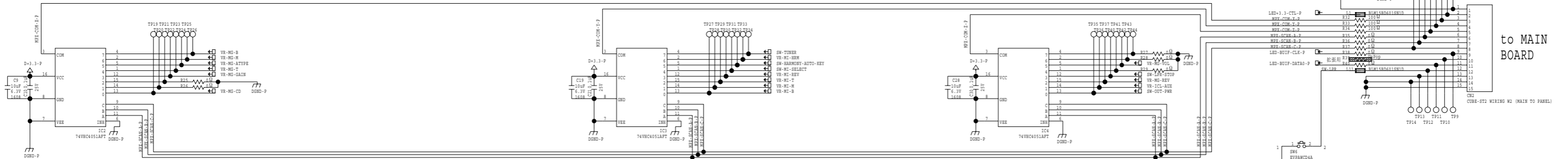

Circuit Diagram (Input Board)

